

GOGGLE

Personal Protective Equipment

Our goggle personal protective equipment (PPE) is the product of choice by healthcare and industry professionals worldwide. It is designed for the protection of the user's face from hazards such as splashes (e.g. chemical liquids), flying objects (e.g. small debris) as well as to control and minimize infections (i.e. protection from sneezing). The goggle is convenient to use, comfortable to wear, durable, made with safe materials and offers an exceptional product quality.

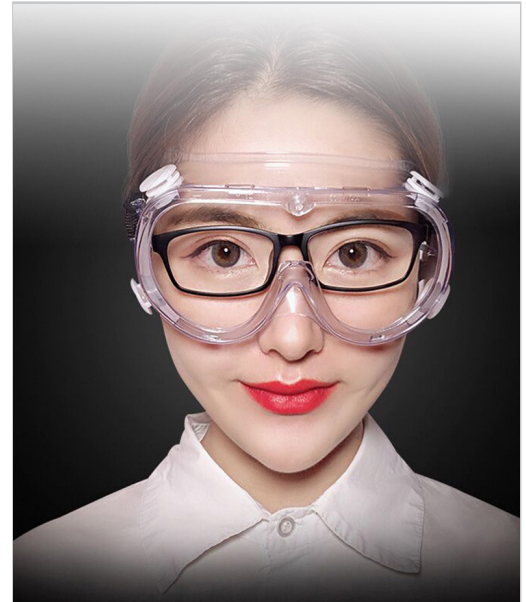

Part number C0804004

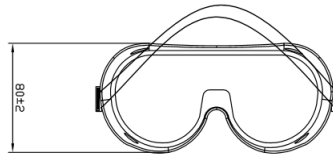
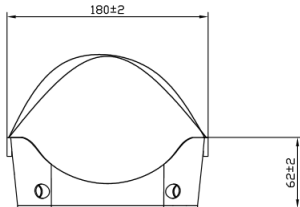

Features

- State of the art, clear PC goggle.
- Comfortable to wear with adjustable band.
- Durable and easy to use.
- Contains four outlet valves to minimize sweating.
- CE and ANSI 87.1 certified.
- Meets EN 166: 2001, EN 167: 2001, EN 168: 2001 standards.
- Does not contain natural latex rubber.



outlet valve



adjustable band



clear PC goggle

Tapmedic LLC reserves the right to make changes to this sheet and the product at any time without notice.



Tapmedic LLC
9424 Baymeadows Rd, Suite 250
Jacksonville, FL 32256 USA
T +1 904-351-0244 F +1 904-351-0245
tapmedic.com | info@tapmedic.com